

Part #: 925E / 926L
Description: SVR11 / SVRXL Striper Installation
Date: 4/03/2024

Instructions for Installing the SVR11 / SVRXL Striper Kit

-NOTE-

The 925E kit is applicable to SVR11-48V, 52V and 61V models with serial numbers of R5700001 and higher. This is not compatible with SVR11-32A, SVR11-36A and SVRXL models.

The 926L kit is applicable to SVRXL-52V, 61V and 72V models with serial number of W9600001 and higher. This is not compatible with SVR11 models.

Please read through and become familiar with these instructions before beginning to install this kit.

DO NOT operate equipment with shields or guards removed.

The following tools are required for installation of the SVR11 Striper Kit p/n 925E and SVRXL Striper Kit p/n 926L

- 1 - 9/16" socket and driver
- 1 - 9/16" wrench

1. Prepare the machine so there is easy and safe access to the work area. Stop the engine, remove the ignition key, wait for all moving parts to come to a complete stop and apply the parking brake. Disconnect the battery cables from the battery making sure to remove the negative (black) cable first followed by the positive (red) cable. Maintain all safety related work procedures. Always wear eye and hand protection.
2. Before beginning installation of this kit, note the serial number of the machine being updated. The 925E kit is applicable to SVR11-48V, 52V and 61V models with serial numbers of R5700001 and higher. This is not compatible with SVR11-32A, SVR11-36A and SVRXL models. The 926L kit is applicable to SVRXL-52V, 61V and 72V models with serial number of W9600001 and higher. This is not compatible with SVR11 models.
3. Remove and discard two (2) 3/8-16 x 1-3/4" hex head bolts and two (2) 3/8-16 elastic stop flange nuts used to secure the LH & RH footplate isolators to the frame of the machine. Retain the 3/8" flat washers for re-use in step 4. See Figure 1.

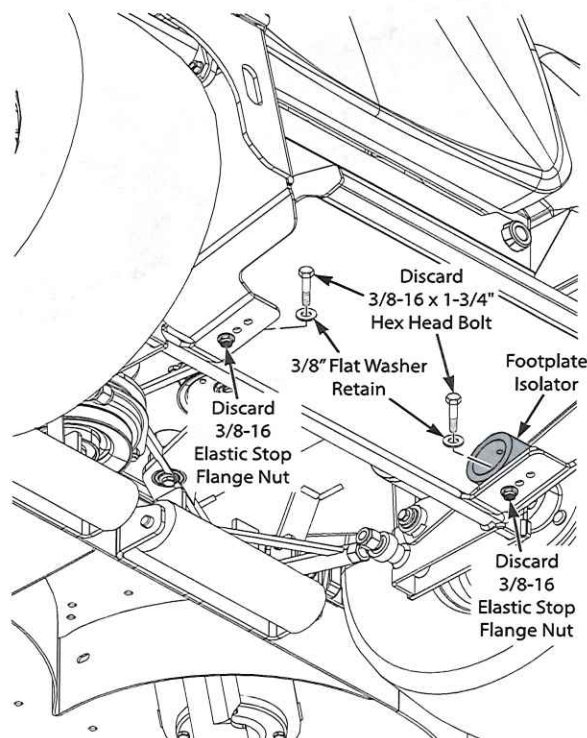

Figure 1. Remove Footplate Isolator Mounting Hardware



INSTRUCTION SHEET 07289 Rev. 2

Part #: 925E / 926L
Description: SVR11 / SVRXL Striper Installation
Date: 4/03/2024

4. Install the striper assembly along with the LH & RH footplate isolators to the frame of the machine. Secure with two (2) 3/8-16 x 2" hex head bolts, two (2) 3/8-16 elastic stop flange nuts supplied with this kit, and the 3/8" flatwashers removed in the previous step. See Figure 2.

-Note-

Inside mounting holes are for the SVR11.
Outside mounting holes are the the SVRXL.

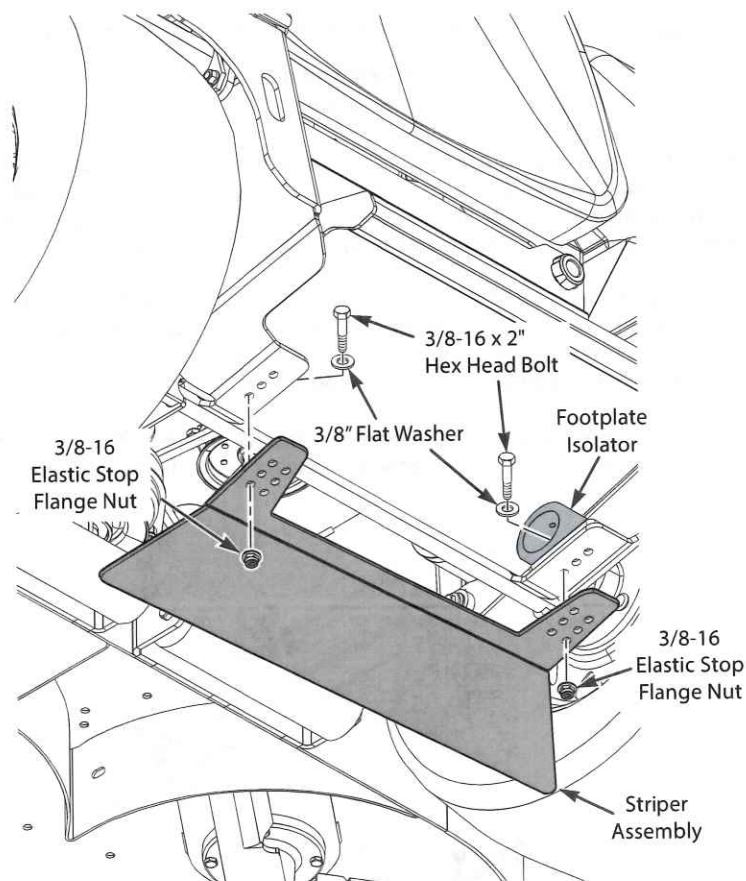

Figure 2. Install Striper Assembly

5. Reconnect the battery cables to the battery making sure to attach the positive (red) cable first followed by the negative (black) cable.
6. Operate and test machine.